

RUSSELL PUMP

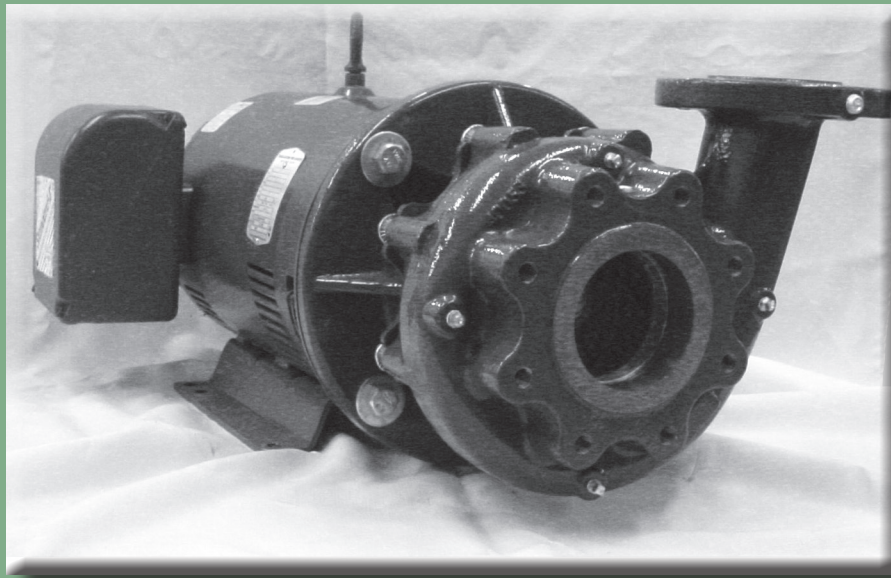

Model A730

End Suction, Close Coupled, Bronze Fitted,
Centrifugal Pump



Typical Applications

General Purpose, OEM, Boosters,
Cooling Towers, Boiler Feed,
Process Fluids, HVAC, Irrigation,
Hot and Chilled Water Circulation

Russell Pump and Engineering Inc.
102 W. Chicago Street
Albion, IA 50005
641-488-2319

Design Features

CASING

Constructed as ASTM A48 class 30 cast iron. The discharge can be mounted in any 90° position. Drain and air ports are also positioned every 90°, 1/4 npt suction and discharge tappings are standard. Back pull out design allows the pump to be serviced without disturbing the piping. The volute was designed to maximize hydraulic efficiency.

MECHANICAL SEAL

Type 21 buna-n seal is rated to 225°F and pressure to 175PSI. Carbon seal face mates with the ceramic seat providing years of trouble free service. Alternate seals available upon request.

IMPELLER

The hydraulic design of the impeller maximize pressure and gpm while minimizing horsepower. The enclosed impeller is made of cast bronze.

ADAPTER

The precise machining of the adapter allows for easy assembly of the pump. A 1/8 npt hole is provided if a seal flush line is added. Construction consists of ASTM A48 class 30 cast iron.

MOTOR

The NEMA JM frame motor utilizes a high carbon steel shaft. The motor's heavy duty ball bearings withstand axial and radial thrust loads with no problem. Standard Enclosure type is drain proof but alternates are available.

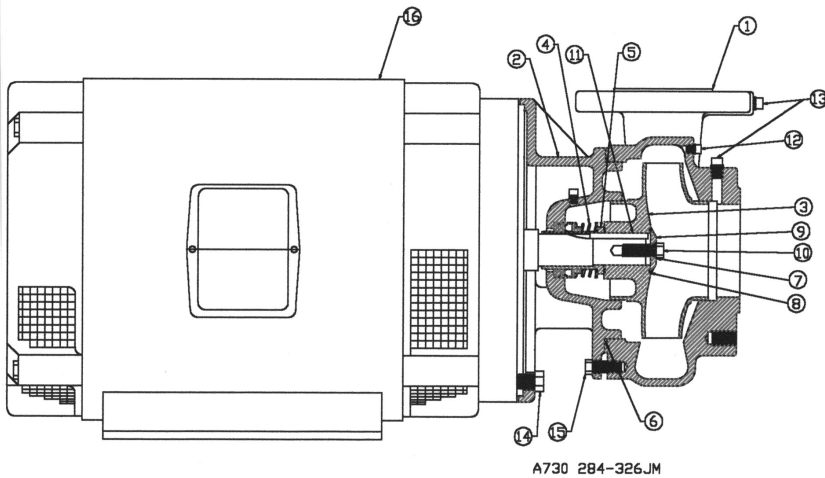

A730 284-326JM

1	CASING A730	CLASS 30 CAST IRON	40053	1
	ADAPTER A7 143-184JM	BRASS	40010	
	ADAPTER A7 213-215JM	CLASS 30 CAST IRON	40011	
	ADAPTER A7 254-326JM		40055	
2	ADAPTER A7 284-326JM		40056	1
	ADAPTER A7 143-184JM		40012	
	ADAPTER A7 213-215JM		40013	
	ADAPTER A7 254-326JM	BRASS		
	ADAPTER A7 284-326JM			
	IMPELLER A730	SILICON BRONZE	40051	
3	IMPELLER A730	SILICON BRONZE	40052	1
	MECHANICAL SEAL 143-215JM	BUNA-N	S-103	
		FPT	S-104	
		VITON	S-105	
4	MECHANICAL SEAL 254-326JM	BUNA-N	S-106	1
		FPT	S-107	
		VITON	S-108	
5	SLEEVE 143-215JM	BRASS	10000	1
	SLEEVE 254-326JM	BRASS	10001	
		BUNA-N	S-129	
6	O-RING CASING	FPT	S-129	1
		VITON	S-130	
	O-RING WASHER 143-215JM	BUNA-N	S-131	
		FPT	S-132	
7	O-RING WASHER 254-326JM	BUNA-N	S-133	1
		FPT	S-134	
		VITON	S-135	
	O-RING IMPELLER 143-215JM	BUNA-N	S-136	
		FPT	S-137	
8	O-RING IMPELLER 254-326JM	BUNA-N	S-138	2
		FPT	S-139	
		VITON	S-140	
	IMPELLER WASHER 143-215JM	BRASS	10002	
9	IMPELLER WASHER 254-326JM	BRASS	10003	1
	IMPELLER CAP SCREW 143-215JM	3/8-16 X 1 BRASS	75020	
10	IMPELLER CAP SCREW 254-326JM	1/2-13 X 1 BRASS	75037	1
	KEY 143-215JM	STAINLESS STEEL	10004	1
	KEY 254-326JM	STAINLESS STEEL	10005	1
12	PIPE PLUG	1/8 NPT BRASS	62925	2
13	CAP SCREW 143-184JM	3/8-16 X 1 STEEL	19991	
14	CAP SCREW 213-215JM	1/2-13 X 1 STEEL	19957	4
	CAP SCREW 254-326JM	5/8-11 X 1 STEEL	19958	
15	CAP SCREW	1/2-13 X 1/4 STEEL	19958	8
16	MOTOR	-	-	1

LIMITATIONS

MAXIMUM WORKING PRESSURE	- 175PSI
MAXIMUM GALLONS PER MINUTE	- 800
MAXIMUM HEAD PRODUCED	- 230FT.
RPM	- 3500 & 1750
MAXIMUM SEAL TEMP BUNA-N	- 225°
EPT	- 300°
VITON	- 400°
MAXIMUM HORSEPOWER	- 40

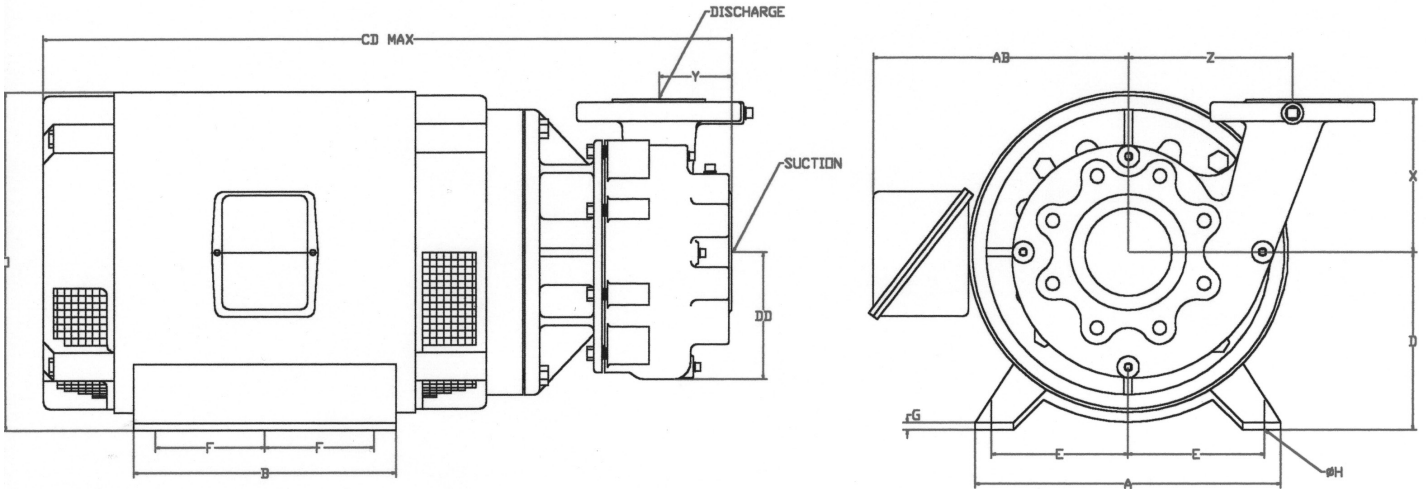

FRAME SIZE	SUCTION	DISCHARGE	A	AB	B	CP	D	DD	E	F	G	H	Ø	X	Y	Z						
143JM	4 FLANGE	3 FLANGE	7	5 1/4	5 15/16	16 31/32 17 15/32	3 1/2	5 3/4	2 3/4	2 2 1/2	1/8	11/32	6 7/8	6 61/64	3 7/16	7 1/32						
145JM			9	5 7/8	6 1/2	19 15/32 20 1/32	4 1/2		3 3/4	2 1/4 2 3/4	3/16	13/32	8 7/16									
182JM			10 1/2	7 3/8	8	22 1/16 23 9/16	5 1/4		4 1/4	2 3/4 3 1/2	1/4	13/32	10 1/16									
184JM			11 1/4	8 15/16	9 1/2 11 3/4	26 31/64 28 15/64	6 1/4		5	4 1/8 5	1/2	17/32	12									
213JM			12 1/4	12 1/4	10 3/4 12 1/4	28 3/8 29 7/8	7		5 1/2	4 3/4 5 1/2	1/2	17/32	13 5/8									
215JM			13 3/16	13 3/16	12 13 1/2	33 3/16 34 3/16	8		6 1/4	5 1/4 6	3/4	21/32	15 9/16									
254JM																						
256JM																						
284JM																						
286JM																						
324JM																						
326JM																						

FRAME SIZE	HORSEPOWER - ODP				HORSEPOWER - TEFC	
	3500RPM 3Ø	3500RPM 1Ø	1750RPM 3Ø	1750RPM 1Ø	3500RPM 3Ø	1750RPM 3Ø
143JM	1, 1 1/2	1 1/2	1	1	1 1/2	1
145JM	2, 3	2	1 1/2, 2	1 1/2	2, 3	1 1/2, 2
182JM	5	3	3	2	3	3
184JM	7 1/2	5	5	3	5	5
213JM	10	7 1/2	7 1/2	5	7 1/2	7 1/2
215JM	15	10	10	7 1/2, 10	10	10
254JM	20	-	15	-	15	15
256JM	25	-	20	-	20	20
284JM	30	-	-	-	-	-
286JM	40	-	-	-	-	-
324JM	50	-	-	-	-	-
326JM	60	-	-	-	-	-

